

LTECH

Full-Color Knob Panel

Model: E6D



Manual

www.ltech-led.com

Product Introduction

- A stylish exterior design combined with innovative, colorful status indicators makes technological interaction intuitive at a glance.
- A 2-in-1 knob controller integrating DALI and Bluetooth, supporting standard DALI and Bluetooth SIG Mesh protocols.
- It supports control and switching among five DALI types: dimming, color temperature adjustment, RGB, RGBW, and RGBCW.
- Equipped with a 200mA bus power output, and can be configured for switching via NFC.
- NFC enables the setting and control of DALI addresses, DALI groups, DALI scenes, and broadcast modes.
- It can be paired with Bluetooth remote controls B1, B2, B5, B8 and RC4-BLE for operation.
- Supports linkage control with the L-Home smart home system and APP, enabling intelligent controls such as local scene settings and automation.
- When paired with a smart gateway, it can achieve linkage control with smart platforms including HomeKit, Siri, Google, Amazon, Xiaomi AI, and Xiaodu.

Specification Parameters

Model	E6D
Output Signal	DALI
Bus Power Current	200mA@16V
Rated Parameters	100-240V~, 50/60Hz
Control Type	DIM, CT, RGB, RGBW, RGBCW
Wireless Type	Bluetooth 5.0 SIG Mesh
Compatible remote control	B1, B2, B5, B8, RC4-BLE
Compatible APP	L-Home, NFC Lighting
Working Temperature	-25°C~50°C
Dimensions	86×86×52mm (L×W×H)
Package Size	102×102×73mm (L×W×H)
Product Weight	130g

Product Size

Unit: mm

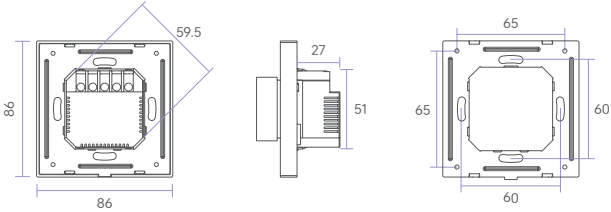

Product Function Description

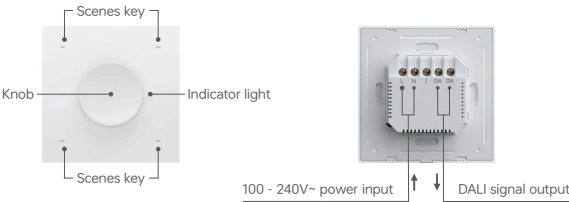

Scenes key: Factory default color temperature mode: the default lamp color temperatures are 2700K (Key 1), 3500K (Key 2), 5000K (Key 3), and 6500K (Key 4); Single press key 1/2/3/4 of the scene key triggers the scene, which requires binding the scene actions via L-Home APP Bluetooth wireless or NFC Lighting APP NFC.

Knob: Supports single click, double click, long press and rotation; supports setting three levels of sensitivity adjustment: high, medium and low.

Indicator light: The corresponding color is displayed according to the current adjustment value of the knob: white (BRT/W), yellow (CT/CW), and purple (RGB). The factory default color is white.

Restore to factory settings: Press and hold the knob for 15 seconds until the indicator light flashes slowly, then release it. Within 3 seconds, press the knob 3 times briefly, and the indicator light will flash quickly.

Introduction to the use of the knob:



Single Press



Double Press



Rotate



Long Press

Note: Different operations are available depending on the configuration type of the knob.

Device \ Action	Single Press	Double Press	Rotate	Long Press
DIM light	ON/OFF	No action	Adjust BRT	Adjust BRT
CT light	ON/OFF	Switch mode: BRT/CT	Adjust current BRT/CT	Adjust BRT
RGB light	ON/OFF	Switch mode: BRT/RGB	Adjust current BRT/RGB color	Adjust BRT
RGBW light	ON/OFF	Switch mode: RGBW BRT/RGB/W	Adjust current RGBW BRT/RGB color/W	Adjust BRT: RGBW/RGB/W
RGBCW light	ON/OFF	Switch mode: RGBCW BRT/RGB/CW	Adjust current RGBCW BRT/RGB color/CW color	Adjust BRT: RGBCW/RGB/CW

Installation Steps

① Turn off the main power switch, and confirm that there are no attachments such as cement on the inner wall of the 86 junction box. Trim the length of the power cord inside the junction box to about 10 cm. Use a flat-blade screwdriver to pry open the bottom box of the knob panel, and find the NFC marking point on the plastic part.



② Use your mobile phone to open the NFC Lighting APP, click [Read/Write Smart Device] on the "Home Page", bring the mobile phone sensing area close to the knob panel NFC identification point, read the knob panel parameters, set the parameters according to your needs (see P8 for details), click [Write] in the upper right corner, and then bring the mobile phone sensing area close to the knob panel NFC identification point, and you can directly write to the knob panel.



③ See Figure 1, after using the mobile phone's NFC to read and write parameters, connect the live wire to the L interface of the smart switch, and the neutral wire to the N interface, and confirm that the power cable is in good contact with the switch binding post and there is no exposed copper wire. (The circuit breaker rating should not exceed 35A)

See Figure 2, fix the bottom box to the wall secret box with screws, so that the bottom box fits the wall.

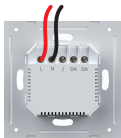
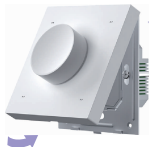

Figure 1



Figure 2

④ Tilt the panel and buckle it on the bottom box, turn on the power main gate, press the knob panel, and you can control the light normally, which means that the installation is correct.



Step 1: Buckle down

Step 2: Buckle the bottom

Connection diagram

- ① When a single E6D device controls multiple drivers, the E6D bus power must be turned on and unified control of multiple drivers can be achieved through broadcasting.

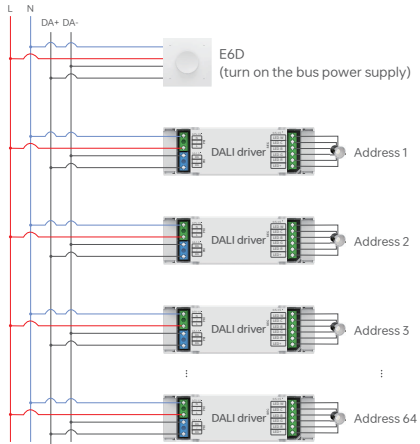

② DALI Bluetooth wireless connection method.

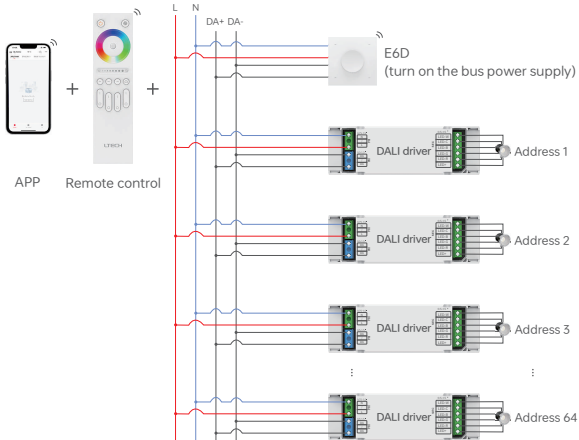

*Please try to avoid wireless drivers being placed next to large areas of metal objects or in spaces with more metal media to avoid interference from being used.

Use with NFC Lighting APP

1. Register an account

Scan and download the QR code through your mobile phone, and follow the prompts to complete the APP installation and log in/register. (Due to performance requirements, the phone model is required for Apple: iPhone 8 and above, and operating system iOS 13 and above; Android: NFC-functional model)



* When setting the device parameters, the operation must be performed when the device is powered off.

2. Read/write knob panel

Click [Read/Write Smart Device] on the "Homepage" of the APP, and bring the phone's sensing area close to the NFC marking point of the knob panel (Figure P4) to read the knob panel parameters.



3.How to set control type and parameters

Control type: Click "Control Type" to select DIM/CT/cRGB/RGBW/RGBCW, default CT.

Parameters: Click "Parameters" to edit the knob's control object, knob sensitivity, double-click on the mode sort, double-click mode memory, indicator light, key press sound, scene key, bus power switch, power on state and other advanced parameters.

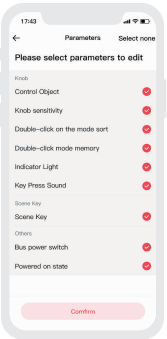
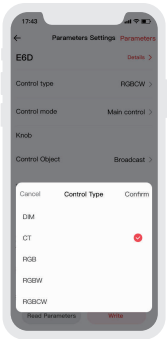
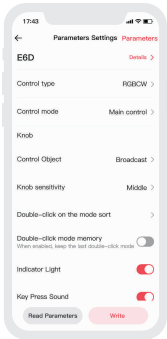

4.How to set knobs and scene keys

Knob: Click "Control Object" to select a single address, group address or broadcast; click "Knob sensitivity" to select a low/medium/high sensitivity; click "Double-click on the mode sort" to adjust the ordering of the total light brightness, RGB mode and W mode (RGBW)/CW mode (RGCW) when double-clicking the knob; turn on/off double-click mode memory, turn off by default; turn on/off indicator light, turn on by default ; turn on/off key press sound, turn on by default..

Scene key: Press and hold the scene key to select the control object or action of the edit scene key, click "Control Object" to select a single address, group address or broadcast, and click "Action" to bind to execute the action.

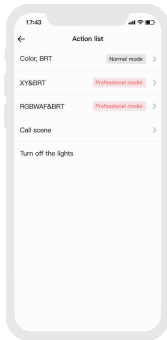
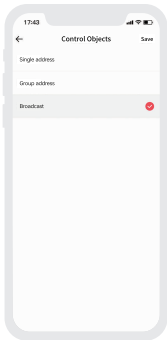
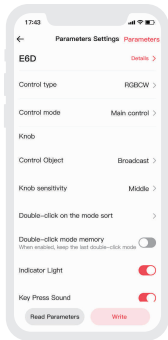

5. Power-on status and factory reset settings

Bus power switch: After turning on, the devices on the DALI bus can withdraw power from the E6D without the need for external DALI bus power; after turning off, the DALI bus power can be connected, which is turned on by default.

Power-on status: You can choose to full bright/light is off/memorize/custom, default memorize.

Restore factory: After clicking the "All parameters are restored to factory default" button, all parameters on the APP page will be restored to factory default value. At this time, you need to click the "Write" button to write the parameters to the device to restore the device to factory settings.

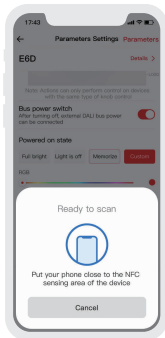
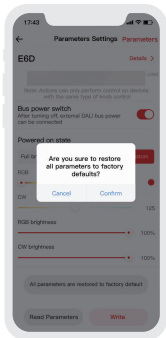

For Use With The L - Home APP.

1. Register an account

Scan the QR code below with your mobile phone. After completing the APP installation according to the prompts, you can proceed with the login/registration operation.



2. Pairing operation

For new users, after creating a home on the APP, click the "+" icon in the upper right corner on the [Room] interface for addition. Select "LED Controller" from the device addition list, and follow the prompts on the installation interface to complete the addition.

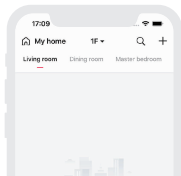

3.How to set knobs and scene keys

Click the added knob panel in the "room" interface to enter the [Control] interface.

Knob: Supports clicking "Control Object" to select single address, group address or broadcast, and also supports clicking the knob to enter the page to adjust the light.

Scene key: Supports clicking "Control Object" to select single address, group address or broadcast, and each key also supports binding different execution actions.

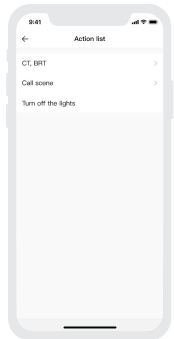
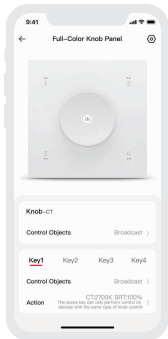

4. Bound by remote control

The knob panel can be bound to the B1/B2/B5/B8/RC4-BLE remote control as a lamp;
Each partition of the remote control supports binding a knob panel;
After binding, the remote control area controls the load on the knob panel.

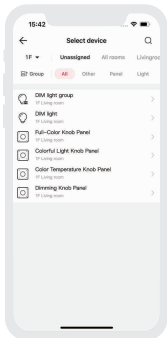
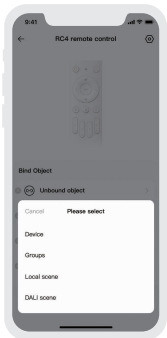
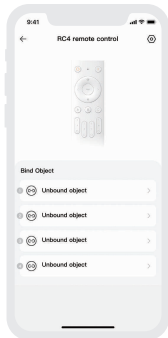

5. How to set scenes and automation

Local scene: Select "Local scene" in the [Smart] interface and click "+" to create a local scene. Click Add Action and select the corresponding device type action.

Cloud scenario: Make sure that smart gateways have been added to the home, such as Super Panel 12S.

Select "Cloud Scene" in the [Smart] interface and click "+" to create a cloud scene. Click Add Action and select the corresponding device type action.

Automation: Ensure that smart gateways have been added to the home, such as the Super Panel 12S.

Select "Automation" in the [Smart] interface and click "+" to create automation. You can choose local/cloud execution method, as well as set trigger conditions and execute actions. When the set trigger conditions are met, a series of device actions are automatically triggered to achieve remote linkage.

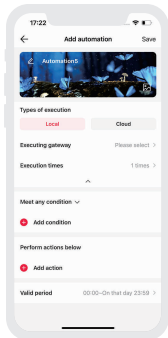
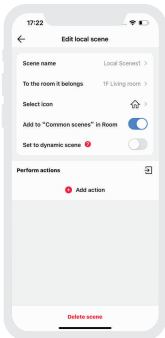
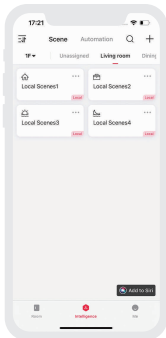

Restore To Factory Settings

Method 1: After the E6D knob panel is connected to power, press the knob for 15 seconds (see Figure 1) until the indicator light flashes slowly and then releases. Press the knob for a short time 3 times within 3 seconds, and the indicator light flashes quickly, indicating that it has returned to the factory settings.

Method 2: First, make sure that the device is properly powered on and in an online state. Then, open the L - Home APP, find the device, and enter its settings page. Click the "Delete Device" button (see Figure 2). When the system prompts "Deletion successful", it means that the device has been successfully restored to its factory settings.



Figure 1

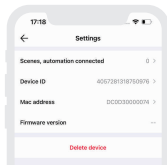

Figure 2

FAQs

1. What to do if the network configuration fails?

- ① Ensure that the device is powered on normally.
- ② Confirm that the device being added has not been added by another account. If it has been added, please manually restore the factory settings.
- ③ Ensure that the mobile phone and the device are as close as possible, preferably within 15 meters.
- ④ If the device has been forcibly deleted, please manually restore the factory settings and then add the device again.

2. How to remotely control the device?

When paired with our company's Smart gateway, the device can be remotely controlled via 4G/5G/WiFi on a mobile phone.

Attentions

- Product installation and commissioning should be done by a qualified professional.
- LTECH products are and not lightningproof non-waterproof (special models excepted). Please avoid the sun and rain. When installed outdoors, please ensure they are mounted in a water proof enclosure or in an area equipped with lightning protection devices .
- Good heat dissipation will prolong the working life of products. Please ensure good ventilation.
- Please check if the working voltage used complies with the parameter requirements of products.
- The diameter of wire used must be able to load the light fixtures you connect and ensure the firm wiring.
- Before you power on products, please make sure all the wiring is correct.
- If a fault occurs, please do not attempt to fix products by yourself. If you have any question, please contact your suppliers.

Warranty Agreement

- Warranty periods from the date of manufacture: 5 years.
- Free repair or replacement services for quality problems are provided within warranty periods.

Warranty exclusions below:

Following conditions are not within the guarantee range of free repairing or replacement services:

- Beyond warranty periods.
 - Any artificial damage caused by high voltage, overload, or improper operations.
 - Products with severe physical damage.
 - Damage caused by natural disasters and force majeure.
 - Warranty labels and barcodes have been damaged.
 - No any contract or invoice signed by LTECH .
1. Repair or replacement provided is the only remedy for customers. LTECH is not liable for any incidental or consequential damage unless it is within the law .
 2. LTECH has the right to amend or adjust the terms of this warranty. The warranty that issues in writing shall prevail.
- * This manual is subject to changes without further notice. Product functions depend on the goods. Please feel free to contact our official distributors if you have any question.

LTECH

全彩旋钮面板

型号: E6D



使用说明书

www.ltech.cn

产品介绍

- 时尚的外观设计配合创新多彩状态指示灯，让科技交互一目了然；
- DALI、蓝牙二合一旋钮控制器，标准DALI、蓝牙SIG Mesh协议；
- 支持控制DALI调光、色温、RGB、RGBW、RGBCW五个类型切换；
- 带200mA总线电源输出，可通过NFC设置开关；
- 通过NFC可设置控制DALI地址、DALI群组、DALI场景、广播模式；
- 可搭配蓝牙遥控器B1、B2、B5、B8、RC4-BLE控制；
- 支持与L-Home智能家居系统，APP联动控制，实现本地场景，自动化等智能控制；
- 搭配智能网关，可以实现HomeKit、Siri、谷歌、亚马逊、小爱、小度等智能平台联动控制。

规格参数

产品型号	E6D
输出信号	DALI
总线电源电流	200mA@16V
额定参数	100-240V~, 50/60Hz
控制类型	调光、色温、RGB、RGBW、RGBCW
无线类型	Bluetooth 5.0 SIG Mesh
可搭配的遥控	B1、B2、B5、B8、RC4-BLE
可搭配的APP	L-Home、NFC Lighting
工作温度	-25°C~50°C
产品尺寸	86×86×52mm (L×W×H)
包装尺寸	102×102×73mm (L×W×H)
产品重量	130g

产品尺寸

单位: mm

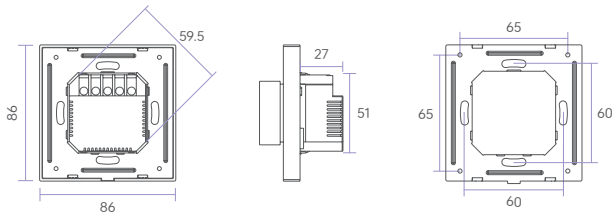

产品功能说明

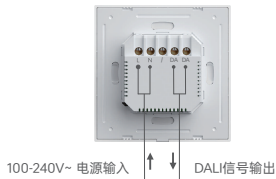
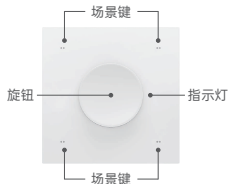

场景键：出厂默认色温模式，默认灯具灯光色温2700K(按键1)、3500K(按键2)、5000K(按键3)、6500K(按键4)；场景键单击按键1/2/3/4触发场景，需要通过 L-Home APP 蓝牙无线 或 NFC Lighting APP NFC方式绑定场景动作。

旋钮：支持单击、双击、长按和旋转；支持设置高、中、低三档灵敏度调节。

指示灯：根据旋钮现在调节的值显示对应颜色，白色(BRT/W)；黄色(CT/CW)；紫色(RGB)，出厂默认白色。

恢复出厂：长按旋钮15秒，直至指示灯慢闪后松开，3秒内短按旋钮3次，指示灯快闪。

旋钮使用介绍：



单击



双击



旋转



长按

注：根据旋钮配置类型具有不同的操作。

设备 \ 动作	单击	双击	旋转	长按
DIM灯	开/关	无动作	调节亮度	亮度±
CT灯	开/关	切换模式 (亮度/色温)	调节当前模式 (亮度/色温)	亮度±
RGB灯	开/关	切换模式 (亮度/RGB)	调节当前模式 (亮度/RGB颜色)	亮度±
RGBW灯	开/关	切换模式 (总亮度/RGB/W)	调节当前模式 (总亮度/RGB颜色/W)	当前模式亮度±
RGBCW灯	开/关	切换模式 (总亮度/RGB/CW)	调节当前模式 (总亮度/RGB颜色/CW颜色)	当前模式亮度±

安装步骤

- ① 关闭电源总闸，并确认86暗盒内壁无水泥等附着物，将暗盒内的电源线长度修减至10CM左右，使用一字螺丝刀撬开旋钮面板底盒，在塑胶部件找到NFC标识点。



- ② 使用手机打开NFC Lighting APP，在“首页”点击【读/写智能设备】，将手机感应区域靠近旋钮面板NFC标识点，读取旋钮面板参数，根据需求设置参数后(详见P8)，点击右上角【写入】，再将手机感应区域靠近旋钮面板NFC标识点，即可直接写入旋钮面板。



- ③ 见图1，使用手机NFC读取写入参数后，将火线接入智能开关L接口，零线接入N接口，确认电源线与开关接线柱接触良好，无裸露的铜线。(电子开关的前置保护装置不能高于35A)
见图2，用螺丝将底盒固定到墙壁暗盒中，使底盒贴合墙面。



图1



图2

- ④ 倾斜面板并扣合在底盒上，开启电源总闸，按下旋钮面板，可正常控制灯光即说明安装正确。

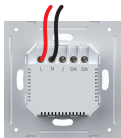

第一步：向下扣合

第二步：底部扣合



连接图

- ① 当单台E6D设备控制多个驱动时，需开启E6D的总线电源，并通过广播方式实现对多驱动的统一控制。

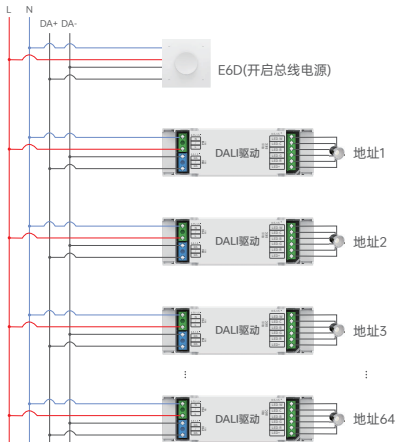

② DALI蓝牙无线连接方式

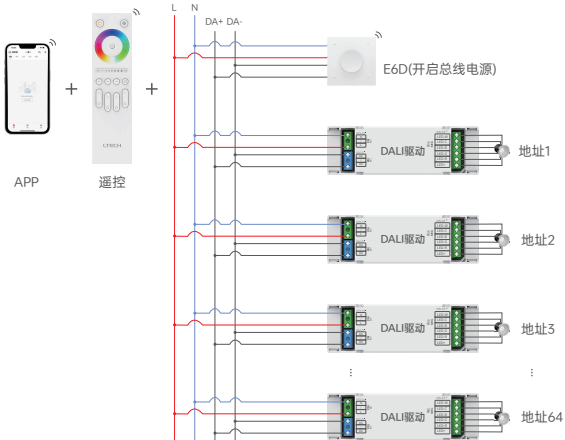

*请尽量避免无线驱动器放置在大面积金属物体旁或在较多金属介质的空间上使用，以免信号受到干扰影响使用。

搭配NFC Lighting APP使用

1. 账号注册

通过手机扫描下方二维码，按提示完成APP安装后即可进行登录/注册操作。(因性能需求，要求手机型号苹果：iPhone8及以上、且操作系统iOS13及以上；安卓：具备NFC功能机型)



* 设置设备参数时，必须在设备断电情况下进行操作。

2. 读/写旋钮面板

在APP“首页”点击【读/写智能设备】，将手机感应区域靠近旋钮面板NFC标识点(图示P4)，读取旋钮面板参数。



3.控制类型和参数管理的设置方式

控制类型：点击“控制类型”可选择调光/色温/彩光RGB/彩光RGBW/彩光RGBCW，默认色温。

参数管理：点击“参数管理”可编辑旋钮的控制对象、旋钮灵敏度、双击模式排序、双击模式记忆、指示灯、按键声音、场景键、总线电源开关、通电状态等更多高级参数。



4. 旋钮和场景键的设置方式

旋钮：点击“控制对象”可选择单地址、组地址或广播；点击“旋钮灵敏度”可选择低/中/高灵敏度；点击“双击模式排序”调整双击旋钮时，灯光总亮度、RGB模式与W模式(RGBW)/CW模式(RGBCW)的排序；开启/关闭双击模式记忆，默认关闭；开启/关闭指示灯开关，默认开启；开启/关闭按键声音，默认开启。

场景键：长按场景键可选择编辑场景键的控制对象或动作，点击“控制对象”可选择单地址、组地址或广播，点击“动作”可绑定执行动作。

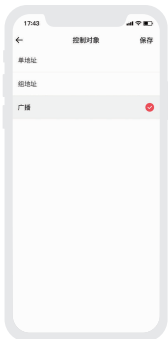

5.通电状态和恢复出厂的设置方式

总线电源开关：开启后，DALI总线上的设备可从E6D进行取电，无需外接DALI总线电源；
关闭后，可外接DALI总线电源，默认开启。

通电状态：可选择全亮/不亮/记忆/自定义，默认记忆。

恢复出厂：点击“所有参数恢复到出厂默认”按钮后，APP页面的所有参数将恢复到出厂默认值，此时，需点击“写入”按钮，把参数写入到设备中，即可将设备恢复出厂设置。



搭配L-Home APP使用

1. 账号注册

通过手机扫描下方二维码，按提示完成APP安装后即可进行登录/注册操作。



2. 配网操作

新用户APP上创建家庭后，在【房间】界面点击右上角“+”进行添加，在添加设备列表中选择“LED控制器”后，按照界面提示完成添加即可。



3. 旋钮和场景键的设置方式

在“房间”界面点击已添加的旋钮面板进入【控制】界面。

旋钮：支持点击“控制对象”选择单地址、组地址或广播，也支持点击旋钮进入页面调节灯光。

场景键：支持点击“控制对象”选择单地址、组地址或广播，每个按键也支持绑定不同的执行动作。



4. 被遥控器绑定

旋钮面板可做灯具被B1/B2/B5/B8/RC4-BLE遥控器绑定；

遥控器的每个分区支持绑定一个旋钮面板；

绑定后，遥控器区域将控制旋钮面板的负载。



5. 场景与自动化的设置方式

本地场景：在【智能】界面中选择“本地场景”，点击“+”创建本地场景。点击添加动作，选择对应设备类型动作即可。

云场景：确保家庭内已添加智能网关，如超级面板12S。

在【智能】界面中选择“云场景”，点击“+”创建云场景。点击添加动作，选择对应设备类型动作设备类型动作即可。

自动化：确保家庭内已添加智能网关，如超级面板12S。

在【智能】界面中选择“自动化”，点击“+”创建自动化。可选择本地/云端执行方式，以及设置触发条件及执行动作。当满足已设置的触发条件时，自动触发一系列设备动作，实现远程联动。

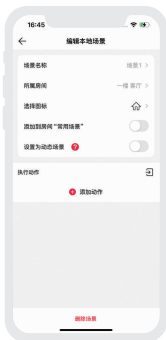

恢复出厂

方法一：

E6D旋钮面板接线上电后，长按旋钮15秒(见图1)，直至指示灯慢闪后松开，3秒内短按旋钮3次，指示灯快闪，表示已恢复到出厂设置。

方法二：

需先确认设备已正确接通电源且处于在线状态。随后，打开L-Home APP，找到该设备并进入其设置页面，点击“删除设备”按钮(见图2)。当系统提示“删除成功”时，即表示设备已成功恢复到出厂设置。



图1



图2

常见问题

1.配网失败怎么办？

- ①确保设备正常通电；
- ②需要确认添加的设备未被其他账号添加过，如被添加过，请手动恢复出厂；
- ③确保手机与设备两者尽量靠近，建议不超过15米；
- ④如设备已被强制删除，请手动恢复出厂，然后重新添加设备。

2.如何远程控制设备？

搭配本司智能网关，可通过4G/5G/WiFi手机远程控制设备。

注意事项

- 请由具有专业资格的人员进行调试安装。
- 雷特产品（专有型号除外）不能防水防雷，需避免日晒雨淋，如安装在户外，请用防水箱和防雷装置。
- 良好的散热条件会延长产品的使用寿命，请把产品安装在通风良好的环境。
- 请检查使用的工作电压是否符合产品的参数要求。
- 使用的电线直径大小必须能够负载连接的LED 灯具，并确保接线牢固。
- 通电调试前，应确保所有接线正确。
- 如果发生故障，请勿私自维修；如果有疑问，请联系供应商。

保修条例

- 自出厂之日起保修服务期为5年。
- 在保修服务期内出现产品质量问题雷特科技将给予免费修理或更换服务。

非保修条例：

属下列情况不在免费保修或更换服务范围之内：

- 已经超出保修服务期；
 - 过高电压、超负载、操作不当等人为造成的损坏；
 - 产品外形严重损坏或变形；
 - 自然灾害以及人力不可抗拒原因造成的损坏；
 - 产品保修标签和产品唯一条形码损坏；
 - 无雷特科技签订的合同或发票凭证。
1. 修理或更换是雷特科技对客户的一补救措施。雷特科技不承担任何附带引起的损害赔偿 responsibility，除非在适用法律范围之内。
 2. 雷特科技享有修正或调整本保修条款的权利，并以书面形式发布为准。

*本说明书的内容如有变更,恕不另行通知。若内容与您使用的功能有所不同,则以实物为准。如有疑问,欢迎向我司授权的经销商咨询。